

Vis TH M8x25
+ Rondelle plate Ø8
+ Ecrou M8
(Screw M8x25 + flat washer Ø8
+ Nut M8)

S 100 U

BP TRCC M6x12 HE

Chemin de câbles tôle
(Cable tray)

AGRAFTOL

Vis TH M8x25
+ Rondelle plate Ø8
+ Ecrou M8
(Screw M8x25 + flat washer Ø8
+ Nut M8)

Pendard UFL
(Bracket UFL)

Chemin de câbles fil
(Mesh tray)

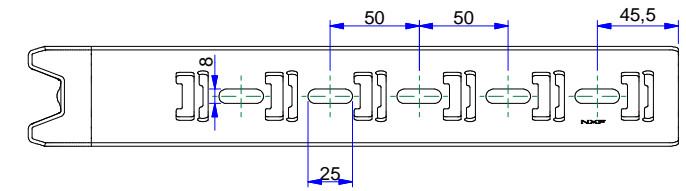
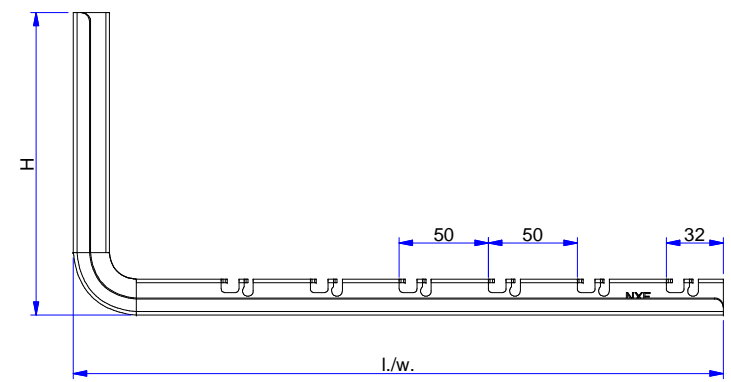
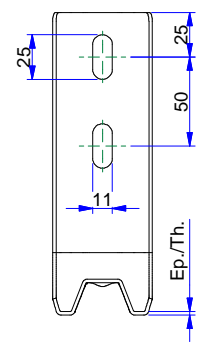



Description	Code	Masse/Weight Kg/p	Ep./Th. mm	H mm	l.w. mm	 daN
UFLP-25 ZM	748033	0,55	2,00	170	315	75
UFLP-30 ZM	748034	0,60	2,00	170	365	64

ZM : High performance coated zinc according to NF A 91102
ZM : Revêtement haute tenue corrosion suivant NF A 91102



www.niedaxfrance.fr

CONSOLE UFLP ZM BRACKET UFLP ZM		
ASSISTANCE TECHNIQUE +33 (0)1 55 95 92 17 pole.technique@niedax.fr		
FT02063		